

Oakleaf Commercial Services New Workshop

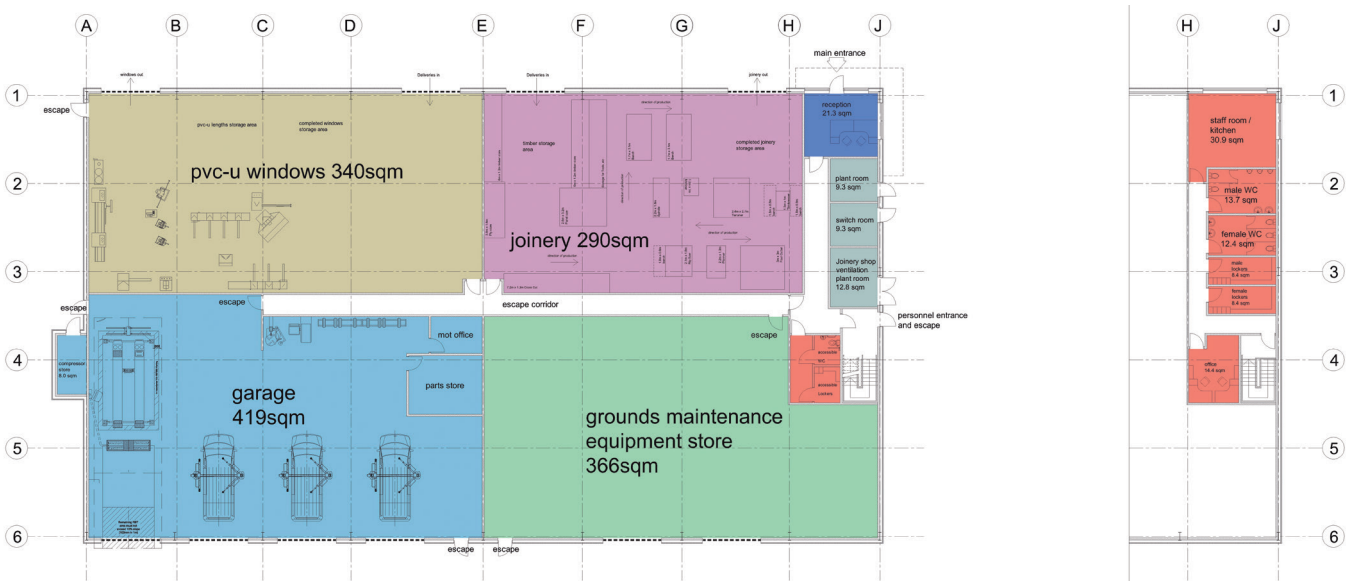

Client Oakleaf Commercial Service
Cost £1.35m
Services Masterplanning

Oakleaf Commercial Services have a number of different departments which are currently in rented accommodation across the Wyre Forest Area. BM3 were appointed in the summer of 2014 to produce a feasibility for a new Workshop to house all the departments under one roof on the remaining plot at Finepoint Way, Kidderminster.

The site was previously owned by Brinton Carpets, who have since vacated the site and they worked with the Planning Department to put a Land Development Order in place to aid development of the site.

The workshop is a steel portal frame, with aluminium cladding as the main covering. There is a feature corner in Siberian Larch which highlights the main reception/entrance into the building.

The 1632sqm workshop has been split into five different areas. Each one has been designed and laid out to suit each specialist activity. This consists of offices, Joinery Shop, UPVC window and door manufacturing, MOT garage for servicing the Ground Maintenance Fleet and the Ground Maintenance vehicle and equipment storage area. Due to the nature of these activities and the shared routes through the building a strict fire strategy was adopted.